

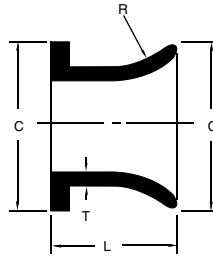

TERMINAL CITY IRON WORKS LTD.

SERVING WESTERN CANADA FOR OVER 100 YEARS



STRAIGHT FLARE PIECES

Size	Wt.	T	C	L	R
3	20	0.40	7.50	8	6
4	30	0.40	9.00	8	6
6	40	0.45	11.00	8	6
8	70	0.53	13.50	10	8
10	95	0.55	16.00	10	10
12	155	0.60	19.00	12	12
14	165	0.65	21.00	12	14
16	240	0.70	23.50	16	16
18	275	0.75	25.00	16	18
20	355	0.80	27.50	18	20
24	480	0.90	32.00	18	24
30	1100	1.07	38.75	24	30
36	1460	1.19	46.00	24	36
42	1900	1.28	53.00	30	42
48	2375	1.42	59.50	18	48

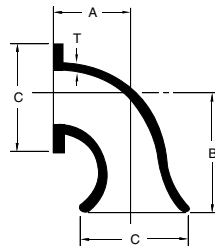

90° FLARE BENDS

Size	Wt	T	C	A	B
3	25	0.40	7.5	5.5	11
4	40	0.40	9.00	6.5	12
6	70	0.45	11.00	8.0	12
8	110	0.53	13.50	9.0	14
10	175	0.55	16.00	11.0	17
12	245	0.60	19.00	12.0	18
14	340	0.65	21.00	14.0	20
16	460	0.70	23.50	15.0	21
18	560	0.75	25.00	16.5	22.5
20	700	0.80	27.50	18.0	24
24	1100	0.90	32.00	22.0	28
30	1840	1.07	38.75	25.0	32
36	2700	1.19	46.00	28.0	35
42	3250	1.28	53.00	31.0	38
48	4425	1.42	59.50	34.0	41