



TERMINAL CITY IRON WORKS LTD.

SERVING WESTERN CANADA FOR OVER 100 YEARS

Ductile Iron Flanged Fittings

45° LATERAL WYES

Size	Wt	H	J	I	T
3	45	10.0	3.0	10.0	0.48
4	75	12.0	3.0	12.0	0.52
6	120	14.5	3.5	14.5	0.55
8	200	17.5	4.5	17.5	0.60
10	335	20.5	5.0	20.5	0.80
12	515	24.5	5.5	24.5	0.87
14	605	27.0	6.0	27.0	0.66
16	805	30.0	6.5	30.0	0.70
18	980	32.0	7.0	32.0	0.75
20	1265	35.0	8.0	35.0	0.80
24	1905	40.5	9.0	40.5	0.89
30	3225	49.0	10.0	49.0	1.03
36	5740	60.0	19.5	60.0	1.15

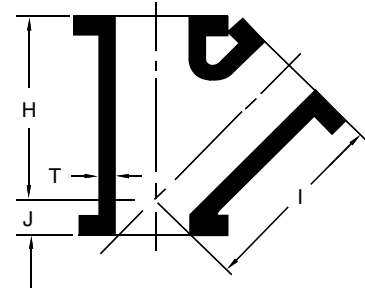

45° REDUCING LATERAL WYES

Size	Wt.	A	B	C	T	T1	Size	Wt.	A	B	C	T	T1
4x3	65	12.0	3.0	12.0	0.52	0.48	18x16	935	32.0	7.0	32.0	0.75	0.70
6x4	105	14.5	3.5	14.5	0.55	0.52	20x8	995	35.0	8.0	35.0	0.80	0.60
8x4	165	17.5	4.5	17.5	0.60	0.52	20x10	1025	35.0	8.0	35.0	0.80	0.68
8x6	175	17.5	4.5	17.5	0.60	0.55	20x12	1065	35.0	8.0	35.0	0.80	0.75
10x4	235	20.5	5.0	20.5	0.68	0.52	20x14	1110	35.0	8.0	35.0	0.80	0.66
10x6	250	20.5	5.0	20.5	0.68	0.55	20x16	1155	35.0	8.0	35.0	0.80	0.70
10x8	270	20.5	5.0	20.5	0.68	0.60	20x18	1315	35.0	8.0	35.0	0.80	0.75
12x4	350	24.5	5.5	24.5	0.75	0.52	24x8	1470	40.5	9.0	40.5	0.89	0.60
12x6	365	24.5	5.5	24.5	0.75	0.55	24x10	1505	40.5	9.0	40.5	0.89	0.68
12x8	390	24.5	5.5	24.5	0.75	0.60	24x12	1550	40.5	9.0	40.5	0.89	0.75
12x10	470	24.5	5.5	24.5	0.75	0.68	24x14	1590	40.5	9.0	40.5	0.89	0.66
14x6	475	27.0	6.0	27.0	0.66	0.55	24x16	1640	40.5	9.0	40.5	0.89	0.70
14x8	500	27.0	6.0	27.0	0.66	0.60	24x18	1685	40.5	9.0	40.5	0.89	0.75
14x10	525	27.0	6.0	27.0	0.66	0.68	24x20	1750	40.5	9.0	40.5	0.89	0.80
14x12	570	27.0	6.0	27.0	0.66	0.75	30x12	2795	49.0	10.0	49.0	1.03	0.75
16x6	620	30.0	6.5	30.0	0.70	0.55	30x14	2850	49.0	10.0	49.0	1.03	0.66
16x8	645	30.0	6.5	30.0	0.70	0.60	30x16	2905	49.0	10.0	49.0	1.03	0.70
16x10	675	30.0	6.5	30.0	0.70	0.68	30x18	2960	49.0	10.0	49.0	1.03	0.75
16x12	715	30.0	6.5	30.0	0.70	0.75	30x20	3040	49.0	10.0	49.0	1.03	0.80
16x14	755	30.0	6.5	30.0	0.70	0.66	30x24	3205	49.0	10.0	49.0	1.03	0.89
18x8	780	32.0	7.0	32.0	0.75	0.60	36x16	4455	54.0	15.3	54.0	1.15	0.70
18x10	810	32.0	7.0	32.0	0.75	0.68	36x18	4505	54.0	15.3	54.0	1.15	0.75
18x12	850	32.0	7.0	32.0	0.75	0.75	36x20	4575	54.0	15.3	54.0	1.15	0.80
18x14	885	32.0	7.0	32.0	0.75	0.66	36x24	4725	54.0	15.3	54.0	1.15	0.89

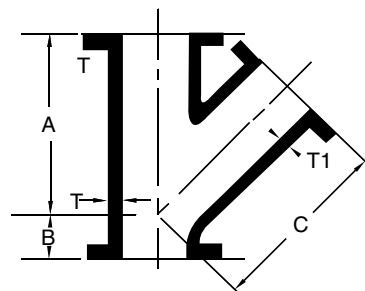

ANSI/AWWA C110/A21.10

Dimensions in inches.
Weights in pounds.