

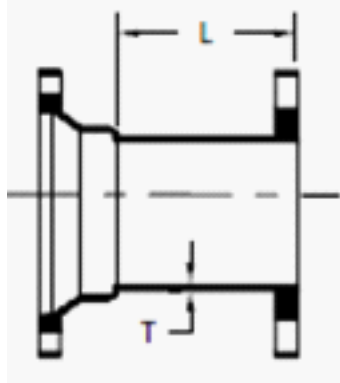

# TERMINAL CITY IRON WORKS LTD.

FULL BODY MECHANICAL JOINT FITTINGS | ANSI/AWWA C110/ A21.10



MJ X FL ADAPTERS			
SIZE	MJDFA		
	T	L	Wt.
3	0.48	8.00	—
4	0.52	8.00	48
6	0.55	8.00	72
8	0.60	8.00	98
10	0.68	8.00	135
12	0.75	8.00	175
14	0.66	8.00	220
16	0.70	8.00	250
18	0.75	8.00	314
20	0.80	8.00	350
24	0.89	8.00	508

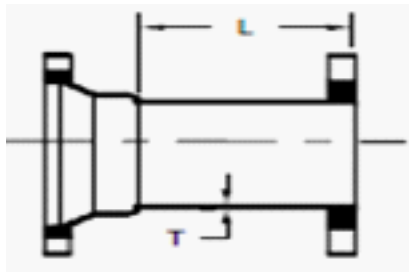

MJ X CL300 FLG ADAPTERS			
SIZE	MJDHFA		
	T	L	Wt.
4	0.48	8.00	60
6	0.52	8.00	90
8	0.55	8.00	125
10	0.60	8.00	174
12	0.68	8.00	230