

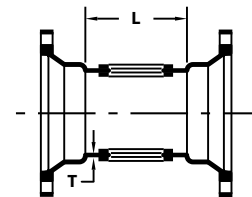

TERMINAL CITY IRON WORKS LTD.

COMPACT MECHANICAL JOINT FITTINGS | ANSI / AWWA C153 / A21.53

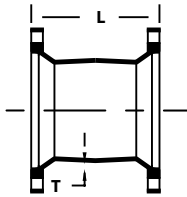
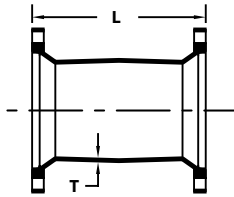

MJ x MJ SLEEVES					
SIZE	T	LONG		SHORT	
		MJSL		MJSS	
		L	Wt.	L	Wt.
2	0.39	12.00	19	7.50	—
3	0.48	12.00	18	7.50	13
4	0.52	12.00	22	7.50	18
6	0.55	12.00	36	7.50	28
8	0.60	12.00	46	7.50	34
10	0.68	12.00	66	7.50	52
12	0.75	12.00	81	7.50	61
14	0.66	15.00	140	9.50	80
16	0.70	15.00	168	9.50	93
18	0.75	15.00	215	9.50	128
20	0.80	15.00	238	9.50	191
24	0.89	15.00	294	9.50	238
30	1.03	24.00	609	15.00	—

MJ X MJ TAPPED TEE				
SIZE	MJTT			
	T	L	TAP	Wt.
3x3	0.48	6.00	2"	27
4x4	0.52	6.00	2"	30
6x6	0.55	6.00	2"	40
8x8	0.60	6.00	2"	59
10x10	0.68	6.00	2"	75
12x12	0.75	6.00	2"	92
14x14	0.66	6.00	2"	—
16x16	0.70	6.00	2"	164

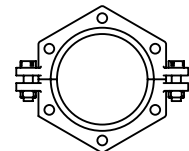
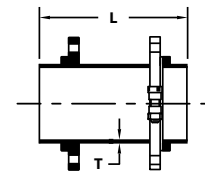

MJ X SW HYDRANT ADAPTERS			
SIZE	MJHA		
	T	L	Wt.
4x13	0.52	13	35
6x13	0.55	13	53
6x18	0.55	18	70
6x24	0.55	24	79
6x36	0.55	36	96
6x48	0.55	48	136
8x13	0.60	13	70
12x13	0.75	13	127