



TERMINAL CITY IRON WORKS LTD.

PUSH-ON JOINT | AWWA C110 FULL BODY FITTINGS

BASIC SPECIFICATIONS

MATERIAL	Ductile Iron ASTM A536
PRESSURE	DI: 4" - 24" 350 psi WWp (2415 k Pa)
TESTING	In accordance with AWWA C110 (ANSI A21.10)
LAYING LENGTH	All Laying Lengths and Metal Thickness to AWWA C110 (ANSI A21.10)
CEMENT LINING	In accordance with AWWA C104 (ANSI A21.4)
COATING	Tar coated (bituminous) inside and out in accordance with AWWA 104 (ANSI 21.4)
GASKETS	SBR in accordance with AWWA C111 (ANSI A21.11)

Bell Specifications for C-110 Full Body Ductile Iron Push-on Fittings

Nom. Pipe Size		B		D		B.C.		H		J		E		F	
in.	mm	in.	mm	in.	mm	in.	mm	in.	mm	in.	mm	in.	mm	in.	mm
4	100	4.90	124	7.08	180	8.00	203	4.00	102	1.72	44	2.58	66	1.25	32
6	150	7.00	178	9.28	236	10.16	258	4.00	102	1.72	44	2.40	61	1.25	32
8	200	9.15	232	11.85	301	12.56	319	4.50	114	1.86	47	3.00	76	1.25	32
10	250	11.20	284	13.68	347	14.94	379	4.50	114	2.06	52	2.88	73	1.25	32
12	300	13.30	338	16.06	406	17.16	436	5.00	127	2.36	60	3.25	83	1.25	32
14	350	15.44	392	19.75	448	18.75	476	5.50	140	2.48	63	3.50	121	1.25	32
16	400	17.54	446	20.14	527	23.88	556	6.00	152	2.98	76	3.50	121	1.25	32
18	450	19.64	499	23.75	603	25.00	635	6.00	152	3.50	89	3.50	121	1.25	32
20	500	21.74	552	26.00	660	27.25	692	6.00	152	3.80	97	3.75	159	1.25	32
24	600	25.94	659	30.50	775	32.00	813	6.00	152	3.80	97	3.75	159	1.25	32

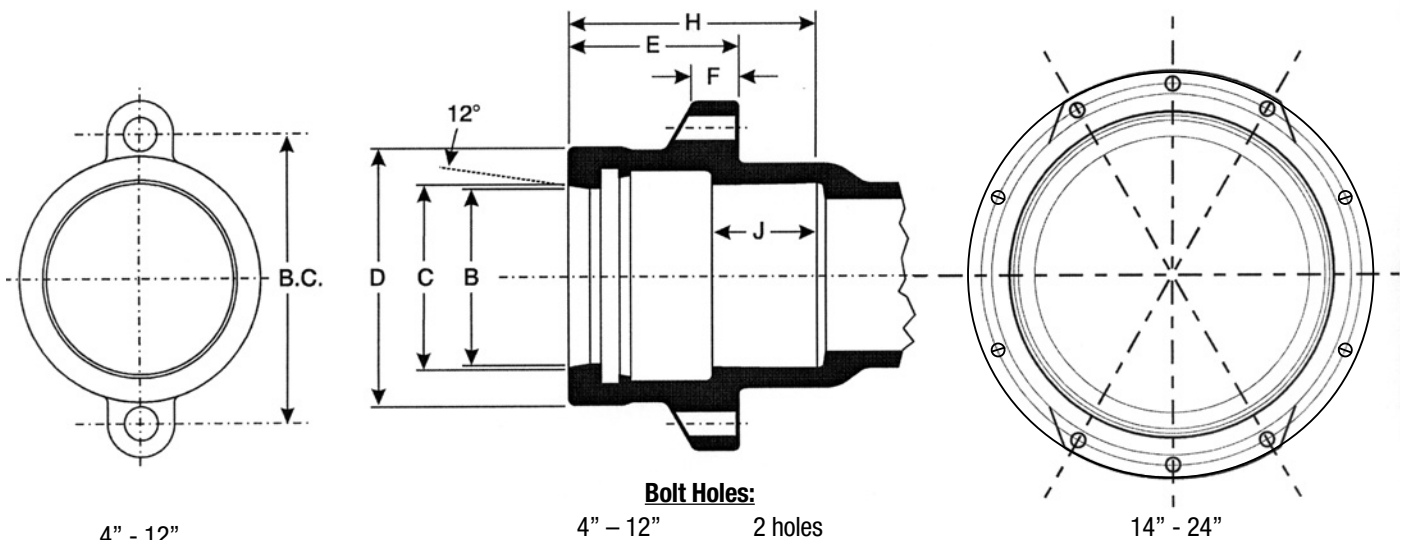

Bolt Holes:

4" - 12"	2 holes
14"	10 holes
16" - 18"	12 holes
20"	14 holes
24"	16 holes



TERMINAL CITY IRON WORKS LTD.

PUSH-ON FULL BODY FITTINGS | ANSI/AWWA C110/ A21.10

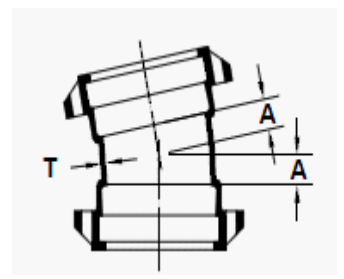
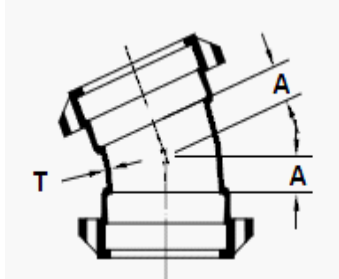
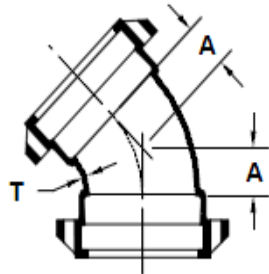
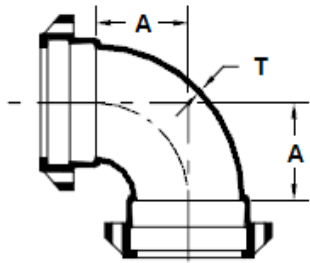

PO X PO BENDS

SIZE	T	PODB		PODB		PODB		PODB	
		90°		45°		22 1/2°		11 1/4°	
		A	Wt.	A	Wt.	A	Wt.	A	Wt.
4	0.52	6.50	57	4.00	—	4.00	—	4.00	—
6	0.55	8.00	110	5.00	85	5.00	88	5.00	86
8	0.60	9.00	154	5.50	132	5.50	137	5.50	133
10	0.68	11.00	228	6.50	196	6.50	200	6.50	216
12	0.75	12.00	336	7.50	278	7.50	275	7.50	275
14	0.66	14.00	379	7.50	309	7.50	325	7.50	321
16	0.70	15.00	530	8.00	434	8.00	422	8.00	429
18	0.75	16.50	669	8.50	503	8.50	520	8.50	518
20	0.80	18.00	—	9.50	—	9.50	—	9.50	—
24	0.89	22.00	1400	11.00	1100	11.00	1050	11.00	1040

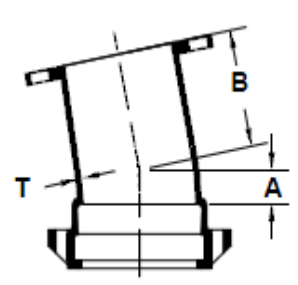
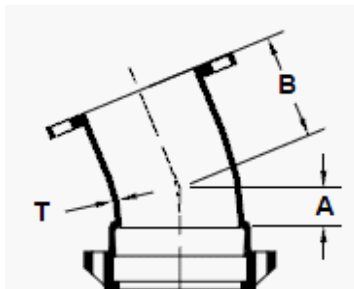
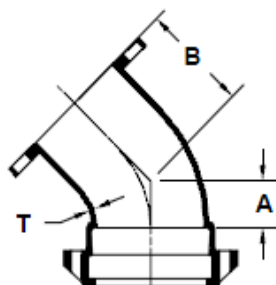
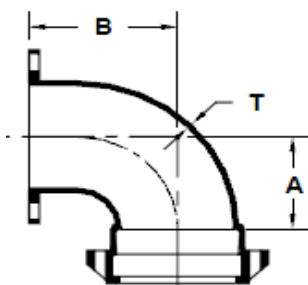

PO X FL BENDS

SIZE	T	PODB		PODB		PODB		PODB	
		90°		45°		22 1/2°		11 1/4°	
		A	Wt.	A	Wt.	A	Wt.	A	Wt.
4	0.52	6.50	—	4.00	—	4.00	—	4.00	—
6	0.55	8.00	—	5.00	71	5.00	—	5.00	—
8	0.60	9.00	—	5.50	110	5.50	—	5.50	—
10	0.68	11.00	—	6.50	185	6.50	—	6.50	—
12	0.75	12.00	—	7.50	262	7.50	—	7.50	—
14	0.66	14.00	—	7.50	—	7.50	—	7.50	—
16	0.70	15.00	—	8.00	—	8.00	—	8.00	—
18	0.75	16.50	—	8.50	—	8.50	—	8.50	—
20	0.80	18.00	—	9.50	—	9.50	—	9.50	—
24	0.89	22.00	—	11.00	—	11.00	—	11.00	—



TERMINAL CITY IRON WORKS LTD.

PUSH-ON FULL BODY FITTINGS | ANSI/AWWA C110/ A21.10

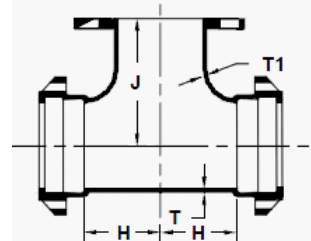
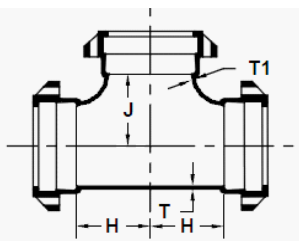

PO XPO TEES

PO X FL TEES

SIZE	T	T1	PODT			PODFT		
			H	J	Wt.	H	J	Wt.
4x4x4	0.52	0.52	6.50	6.50	—	6.50	6.50	—
6x6x4	0.55	0.52	8.00	8.00	—	8.00	8.00	136
6x6x6	0.55	0.55	8.00	8.00	—	8.00	8.00	135
8x8x4	0.60	0.52	9.00	9.00	—	9.00	9.00	190
8x8x6	0.60	0.55	9.00	9.00	212	9.00	9.00	196
8x8x8	0.60	0.60	9.00	9.00	223	9.00	9.00	—
10x10x4	0.68	0.52	11.00	11.00	280	11.00	11.00	294
10x10x6	0.68	0.55	11.00	11.00	295	11.00	11.00	267
10x10x8	0.68	0.60	11.00	11.00	312	11.00	11.00	331
10x10x10	0.80	0.80	11.00	11.00	362	11.00	11.00	375
12x12x4	0.75	0.52	12.00	12.00	—	12.00	12.00	400
12x12x6	0.75	0.55	12.00	12.00	402	12.00	12.00	400
12x12x8	0.75	0.60	12.00	12.00	425	12.00	12.00	430
12x12x10	0.87	0.80	12.00	12.00	462	12.00	12.00	459
12x12x12	0.87	0.87	12.00	12.00	514	12.00	12.00	446
14x14x6	0.66	0.55	14.00	14.00	463	14.00	14.00	—
14x14x8	0.66	0.60	14.00	14.00	484	14.00	14.00	—
14x14x10	0.66	0.68	14.00	14.00	532	14.00	14.00	—
14x14x12	0.82	0.75	14.00	14.00	562	14.00	14.00	—
14x14x14	0.82	0.82	14.00	14.00	561	14.00	14.00	630
16x16x6	0.70	0.55	15.00	15.00	580	15.00	15.00	650
16x16x8	0.70	0.60	15.00	15.00	587	15.00	15.00	—
16x16x10	0.70	0.68	15.00	15.00	653	15.00	15.00	—
16x16x12	0.70	0.75	15.00	15.00	636	15.00	15.00	—
16x16x14	0.89	0.82	15.00	15.00	—	15.00	15.00	—
16x16x16	0.89	0.89	15.00	15.00	787	15.00	15.00	679
18x18x6	0.75	0.55	13.00	15.50	671	13.00	15.50	—
18x18x8	0.75	0.60	13.00	15.50	701	13.00	15.50	—
18x18x10	0.75	0.68	13.00	15.50	733	13.00	15.50	—
18x18x12	0.75	0.75	13.00	15.50	743	13.00	15.50	—
18x18x14	0.75	0.66	16.50	16.50	870	16.50	16.50	—
18x18x16	0.96	0.89	16.50	16.50	886	16.50	16.50	—
18x18x18	0.96	0.96	16.50	16.50	916	16.50	16.50	—
24x24x6	0.89	0.55	15.00	19.00	—	15.00	19.00	—
24x24x8	0.89	0.60	15.00	19.00	1230	15.00	19.00	—
24x24x12	0.89	0.75	15.00	19.00	1300	15.00	19.00	—
24x24x16	0.89	0.70	15.00	19.00	1380	15.00	19.00	—
24x24x18	0.89	0.75	22.00	22.00	1830	22.00	22.00	—
24x24x24	1.16	1.16	22.00	22.00	2400	22.00	22.00	—



TERMINAL CITY IRON WORKS LTD.

PUSH-ON FULL BODY FITTINGS | ANSI/AWWA C110/ A21.10

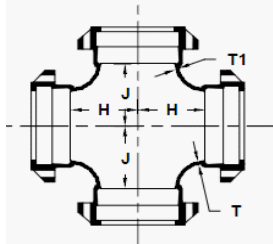

PO CROSSES

SIZE	PODT				
	T	T1	H	J	Wt.
6x6	0.55	0.55	8.00	8.00	195
8x4	0.60	0.52	9.00	9.00	—
8x6	0.60	0.55	9.00	9.00	250
8x8	0.60	0.60	9.00	9.00	280
10x6	0.68	0.55	11.00	11.00	300
10x8	0.68	0.60	11.00	11.00	380
10x10	0.80	0.80	11.00	11.00	410
12x6	0.75	0.55	12.00	12.00	435
12x8	0.75	0.60	12.00	12.00	420
12x10	0.87	0.80	12.00	12.00	505
12x12	0.87	0.87	12.00	12.00	530
14x6	0.66	0.55	14.00	14.00	545
14x14	0.82	0.82	14.00	14.00	735
16x8	0.70	0.60	15.00	15.00	700
16x16	0.89	0.89	15.00	15.00	970
18x6	0.75	0.55	13.00	15.50	701
18x8	0.75	0.60	13.00	15.50	740
18x10	0.75	0.68	13.00	15.50	794
18x12	0.75	0.75	13.00	15.50	783
18x14	0.75	0.66	16.50	16.50	1033
18x18	0.96	0.96	16.50	16.50	1195



TERMINAL CITY IRON WORKS LTD.

PUSH-ON FULL BODY FITTINGS | ANSI/AWWA C110/ A21.10

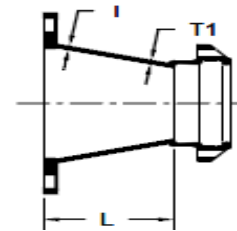
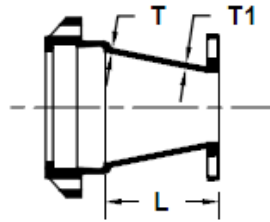
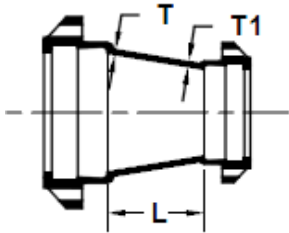

PO X PO REDUCERS

PO X FL REDUCERS

FL X PO REDUCERS

SIZE	T	T1	PODR		PODFR		FPODR	
			L	Wt.	L	Wt.	L	Wt.
4x3	0.52	0.50	—	—	—	40	—	—
6x4	0.55	0.52	9.00	63	—	—	—	—
8x4	0.60	0.52	11.00	90	—	—	—	—
8x6	0.60	0.55	11.00	118	—	—	—	—
10x4	0.68	0.52	12.00	139	—	—	—	—
10x6	0.68	0.55	12.00	126	—	—	—	—
10x8	0.68	0.60	12.00	172	—	—	—	—
12x4	0.75	0.52	14.00	155	—	—	—	—
12x6	0.75	0.55	14.00	175	—	—	—	—
12x8	0.75	0.60	14.00	199	—	—	—	—
12x10	0.75	0.68	14.00	235	—	—	—	—
14x6	0.66	0.55	16.00	220	—	—	—	—
14x8	0.66	0.60	16.00	299	—	—	—	—
14x10	0.66	0.68	16.00	263	—	—	—	—
14x12	0.66	0.75	16.00	291	—	—	—	—
16x6	0.70	0.55	18.00	276	—	—	—	—
16x8	0.70	0.60	18.00	330	—	—	—	—
16x10	0.70	0.68	18.00	340	—	—	—	—
16x12	0.70	0.75	18.00	369	—	—	—	—
16x14	0.70	0.66	18.00	380	—	—	—	—
18x12	0.75	0.75	19.00	405	—	—	—	—
18x14	0.75	0.66	19.00	418	—	—	—	—
18x16	0.75	0.70	19.00	493	—	—	—	—
24x12	0.89	0.75	24.00	770	—	—	—	—
24x16	0.89	0.70	24.00	820	—	—	—	—
24x18	0.89	0.75	24.00	880	—	—	—	—



TERMINAL CITY IRON WORKS LTD.

PUSH-ON FULL BODY FITTINGS | ANSI/AWWA C110/ A21.10

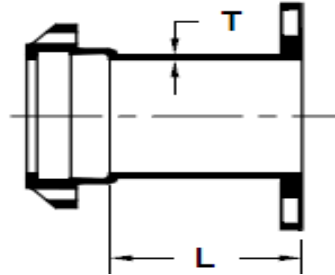

PO X FL ADAPTERS			
SIZE	PODFA		
	T	L	Wt.
4	0.52	8.00	45.00
6	0.55	8.00	80.00
8	0.60	8.00	160.00
10	0.68	8.00	130.00
12	0.75	8.00	180.00
14	0.66	8.00	294.00
16	0.70	8.00	306.00
18	0.75	8.00	343.00
20	0.80	8.00	—
24	0.89	8.00	650.00



TERMINAL CITY IRON WORKS LTD.

PUSH-ON FULL BODY FITTINGS | ANSI/AWWA C110/ A21.10



PO SOLID & TAPPED CAPS					PO SOLID & TAPPED PLUGS				
SIZE	T	PODC	PODCT		SIZE	T	PODP	PODPT	
		Wt.	Tap	Wt.			Wt.	Tap	Wt.
4	0.52	29	2"	25	4	0.52	18	2"	17
6	0.55	30	2"	30	6	0.55	29	2"	32
8	0.60	56	2"	52	8	0.60	50	2"	54
10	0.68	64	2"	71	10	0.68	75	2"	77
12	0.75	110	2"	112	12	0.75	100	2"	103
14	0.66	146	2"	—	14	0.66	119	2"	122
16	0.70	187	2"	—	16	0.70	148	2"	155
18	0.75	255	2"	—	18	0.75	181	2"	180
20	0.80	—	2"	—	20	0.80	—	2"	—
24	0.89	492	2"	—	24	0.89	425	2"	420



TERMINAL CITY IRON WORKS LTD.

PUSH-ON JOINT FULL BODY DUCTILE IRON FITTINGS | ANSI / AWWA C110

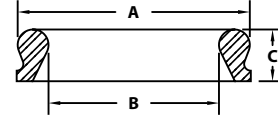
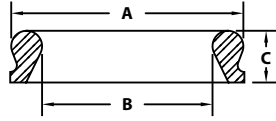

PO GASKETS			
NOM. SIZE	A	B	C
4	5.74	4.54	1.00
6	7.86	6.64	1.00
8	10.15	8.73	1.21
10	12.22	10.80	1.30
12	14.34	12.92	1.30
14	16.90	15.90	1.65
16	19.01	17.01	1.65
18	21.13	19.13	1.65
20	23.25	21.25	1.65
24	27.48	25.48	1.65

PO TRANSITION GASKETS			
NOM. SIZE	A	B	C
4	5.74	4.18	1.00
6	7.86	6.31	1.10
8	10.15	8.32	1.29
10	12.22	10.30	1.36
12	14.34	12.70	1.45

Standard push-on gaskets are Styrene-Butadiene (SBR) and also are available in Nitrile (NBR).